

## SKINTOP® MS-HF-M

SKINTOP® MS-M, brass cable gland for cable diameters up to 98mm, in areas where mechanical and chemical stability are critical

### Info

Cable gland for railway applications  
Hazard Level: HL 3

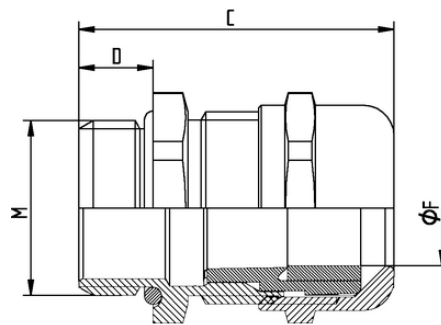

Rail



Flame-retardant



Halogen-free



Reliability

### Benefits

Halogen-free and flame-retardant  
Optimum strain relief  
Wide, variable clamping ranges  
Maximum reliability

### Application range

Underground railways and trains  
In areas where mechanical and chemical stability are critical  
When the protection of people and property is a priority

### Norm references / Approvals

DIN EN 45545-2 (HL3)  
DIN EN 45545-3 (E30)

Last Update (16.09.2019)

©2019 Lapp Group - Technical changes reserved

Product Management [www.lappkabel.de](http://www.lappkabel.de)

You can find the current technical data in the corresponding data sheet.

PN 0456 / 02\_03.16

## SKINTOP® MS-HF-M

### Product Make-up

Metric connection thread acc. to DIN EN 60423  
Basis for technical information DIN IEC 62444

### Note

Refer to SKINTOP® metric accessories for suitable accessories

### Technical Data

Classification ETIM 5:	ETIM 5.0 Class-ID: EC000441 ETIM 5.0 Class-Description: Cable screw gland
Classification ETIM 6:	ETIM 6.0 Class-ID: EC000441 ETIM 6.0 Class-Description: Cable screw gland
Caution:	Refer to Appendix T21 for the installation dimensions and torques
Material:	Body: nickel-plated brass Insert: halogenfree polyamide acc. to UL 94 V0 Sealing: special elastomere O-ring: special elastomere
Protection rating:	IP 68 - 5 bar
Temperature range:	Dynamic: -25°C up to + 100°C Fixed: -40°C to +100°C

### Note

Photographs and graphics are not to scale and do not represent detailed images of the respective products.  
Prices are net prices without VAT and surcharges. Sale to business customers only.

**SKINTOP® MS-HF-M**

Article number	Article designation / size	Clamping range ØF mm	SW wrench size mm	Overall length C mm	Thread length D mm	Pieces / PU
53112570	M 12 x 1,5	3.5 - 7	16	26.5	6.5	100
53112571	M 16 x 1,5	4.5 - 10	20	33.0	7	100
53112572	M 20 x 1,5	7 - 13	24	37.0	8	50
53112573	M 25 x 1,5	9 - 17	29	38.5	8	25
53112574	M 32 x 1,5	11 - 21	36	45.5	9	25
53112575	M 40 x 1,5	19 - 28	45	48.0	9	10
53112576	M 50 x 1,5	27 - 35	54	55.5	10	5
53112577	M 63 x 1,5	34 - 45	67	67.0	15	5

Last Update (16.09.2019)

©2019 Lapp Group - Technical changes reserved

Product Management [www.lappkabel.de](http://www.lappkabel.de)You can find the current technical data in the corresponding data sheet.  
PN 0456 / 02\_03.16