

EPIC® POWER LS1 G5

Circular connectors for servomotors and power supply

EPIC® LS1 Power connector panel base with M25 thread for male contacts

Info

Made in Germany

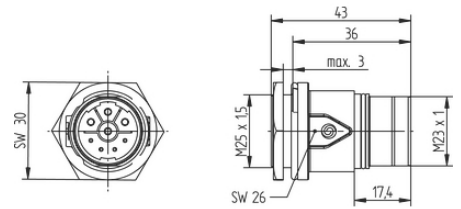
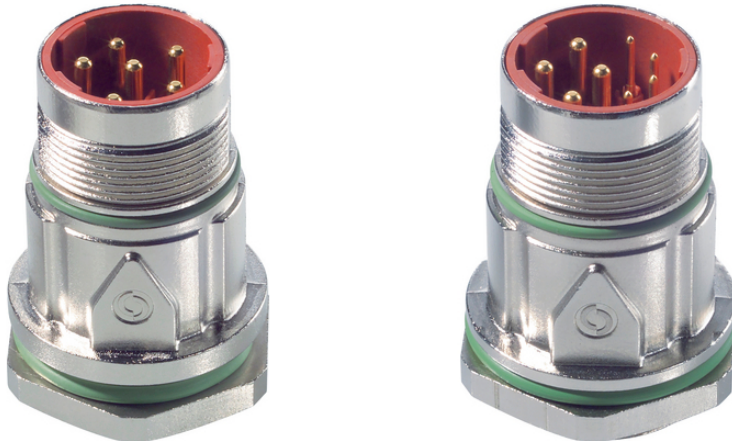

- Mechanical and plant engineering
- Wind Energy
- Good chemical resistance
- Corrosion-resistant
- Maximum vibration protection
- Mechanical resistance
- Assembly time
- Space requirement
- Robust

Last Update (11.12.2022)

©2022 Lapp Group - Technical changes reserved

Product Management www.lappkabel.de

You can find the current technical data in the corresponding data sheet.

PN 0456 / 02_03.16

EPIC® POWER LS1 G5



Interference signals



Waterproof



Variety of approval certifications

Benefits

High power at smallest installation space, Optimal solution for electric motors
 EMC-optimised design
 Safety use in field environment by high protection class

Application range

Plant engineering
 Servo drives and servo assemblies

Technical Data

Classification ETIM 5:	ETIM 5.0 Class-ID: EC002635 ETIM 5.0 Class-Description: Circular connector (industrial connector)
Classification ETIM 6:	ETIM 6.0 Class-ID: EC002635 ETIM 6.0 Class-Description: Circular connector (industrial connector)
Rated voltage (V):	630 V (2 mm contacts) 250 V (1 mm contacts)
Rated impulse voltage:	6 kV (2 mm contacts) 4 kV (1 mm contacts)
Rated current (A):	26A/3+PE+4, 25A/5+PE (2mm contacts) 7 A (1 mm contacts)
Pollution degree:	3
Contact resistance:	< 4 mOhm
Contacts:	Gold-plated brass
Number of contacts:	3+PE+4(2mm/1mm) 5+PE(2mm)
Termination methods:	Crimp termination: 0.5 - 2.5 mm ² (2 mm contacts) Crimp termination: 0.14 - 1.0 mm ² (1 mm contacts)
Material:	Housing: nickel-plated zinc die-casting, nickel-plated brass Insert: PA, Seal: FPM
Protection rating:	IP68 (10h/1m)
Cycle of mechanical operation:	500
VDE-tested:	Certified production control: VDE-REG. no. B25 UL File Number: E249137
Temperature range:	-25°C up to +125°C

EPIC® POWER LS1 G5

Note

Photographs and graphics are not to scale and do not represent detailed images of the respective products.
Prices are net prices without VAT and surcharges. Sale to business customers only.

EPIC® POWER LS1 G5

Article number	Article description	Contacts included	Clamping range in mm	Fastening type	Pin configuration	Pieces / PU
Type LS1 G5, front wall mounting, 6-pin, for male contacts						
76153000	LS1 G5	6	-	M25 x 1.5 (with nut)	5+PE	5
76153510	LS1 G5	-	-	M25 x 1.5 (with nut)	5+PE	20
Type LS1 G5, front wall mouning, 8-pin, for male contacts						
76154000	LS1 G5	8	-	M25 x 1.5 (with nut)	3+PE+4	5
76154510	LS1 G5	-	-	M25 x 1.5 (with nut)	3+PE+4	20

Last Update (11.12.2022)

©2022 Lapp Group - Technical changes reserved

Product Management www.lappkabel.deYou can find the current technical data in the corresponding data sheet.
PN 0456 / 02_03.16