

EPIC® SIGNAL M23 B1

Circular connectors for Servo Cables and encoders

EPIC® M23 panel base for back wall assembly

Info

Housing for mounting at inner side to save space outside of device

Made in Germany

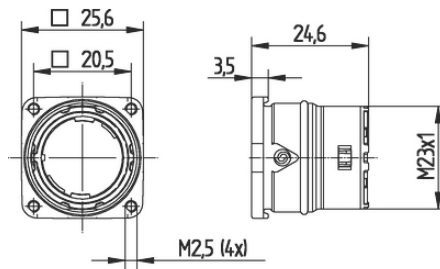

Mechanical and plant engineering



Wind Energy



Good chemical resistance



Robust



Interference signals

Benefits

Defined stop position when mounting at device prevents uncontrolled pressing of sealing
 Harnesses insulation body can easily be inserted from back side in already mounted housing

Application range

Plant engineering
 Servo drives and servo assemblies
 Measurement and control technology

Technical Data

Last Update (06.06.2023)

©2023 Lapp Group - Technical changes reserved

Product Management www.lappkabel.de

You can find the current technical data in the corresponding data sheet.

PN 0456 / 02_03.16

EPIC® SIGNAL M23 B1

| | |
|------------------------|--|
| Classification ETIM 5: | ETIM 5.0 Class-ID: EC000437 ETIM 5.0 Class-Description: Housing for industrial connectors |
| Classification ETIM 6: | ETIM 6.0 Class-ID: EC000437 ETIM 6.0 Class-Description: Housing for industrial connectors |
| Material: | Housing: nickel-plated zinc die-casting Sealing: FPM |
| Protection rating: | IP68 (10h/1m) |
| VDE-tested: | Certified production control: VDE-REG. no. C24 (according to EN 61984, SELV according to DIN VDE 0100-410 has to be guaranteed) UL File Number: E249137 |
| Temperature range: | -25°C up to +125°C |

Note

Photographs and graphics are not to scale and do not represent detailed images of the respective products.
Prices are net prices without VAT and surcharges. Sale to business customers only.

EPIC® SIGNAL M23 B1

| Article number | Article | Coding | Fastening type | Pieces / PU |
|---|---------|-------------|----------------|-------------|
| Type M23 B1 panel-mount box, rear wall mounting | | | | |
| 44420024 | M23 B1 | black (N) | M2.5 (4x) | 5 |
| 44420023 | M23 B1 | black (N) | M2.5 (4x) | 20 |
| 44420026 | M23 B1 | red (+20°) | M2.5 (4x) | 5 |
| 44420025 | M23 B1 | red (+20°) | M2.5 (4x) | 20 |
| 44420022 | M23 B1 | blue (-20°) | M2.5 (4x) | 5 |
| 44420021 | M23 B1 | blue (-20°) | M2.5 (4x) | 20 |

Last Update (06.06.2023)

©2023 Lapp Group - Technical changes reserved

Product Management www.lappkabel.deYou can find the current technical data in the corresponding data sheet.
PN 0456 / 02_03_16