

EPIC® H-A 32 SDR-BO

Rugged housings for 2 inserts

The compact housing for two inserts of the H-A, H-D or STA narrow series is suitable for space-saving applications.

Info

Compact, robust metal housings for double size H-A 32

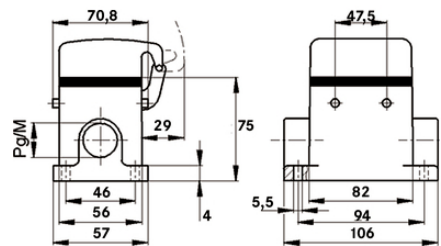

Mechanical and plant engineering



Mechanical resistance



Robust



Waterproof

Benefits

For two inserts of the small H-A, H-D and STA series. Space-saving

Application range

Machine and equipment manufacturing
Control engineering

Product features

Surface-mount base
Bolts for double lever
1 cable entry
Metal cover

Technical Data

Last Update (11.02.2020)

©2020 Lapp Group - Technical changes reserved

Product Management www.lappkabel.de

You can find the current technical data in the corresponding data sheet.

PN 0456 / 02_03.16

EPIC® H-A 32 SDR-BO

Classification ETIM 5:	ETIM 5.0 Class-ID: EC000437 ETIM 5.0 Class-Description: Housing for industrial connectors
Classification ETIM 6:	ETIM 6.0 Class-ID: EC000437 ETIM 6.0 Class-Description: Housing for industrial connectors
Material:	Housing: aluminium alloy, grey Lever: zinc-plated steel Sealing: NBR
Protection rating:	IP 65 (latched) IP 40 (cover closed)
Temperature range:	-40°C to +100°C, short-term up to +125°C

Note

Photographs and graphics are not to scale and do not represent detailed images of the respective products. Prices are net prices without VAT and surcharges. Sale to business customers only.

EPIC® H-A 32 SDR-BO

Article number	Article description	PG	Neck	Pieces / PU
H-A housing: surface-mount base (cover, 1 cable entry, bolts for double lever)				
70515200	H-A 32 SDR-BO 21	21	yes	5
70515400	H-A 32 SDR-BO 29	29	yes	5
79515200	H-A 32 SDR-BO M25	-	yes	5
79515400	H-A 32 SDR-BO M32	-	yes	5

Last Update (11.02.2020)

©2020 Lapp Group - Technical changes reserved

Product Management www.lappkabel.de

You can find the current technical data in the corresponding data sheet.

PN 0456 / 02_03.16