

## Conductor end sleeves AH, not insulated

Uninsulated/not-insulated conductor end sleeves for cabinet builders

### Info

Now with UL approval

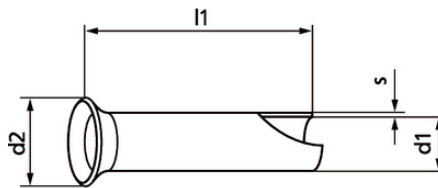

### Benefits

Slightly funnel-shaped opening makes it easy to slip it onto the core

### Application range

Control cabinet wiring

### Norm references / Approvals

In accordance with DIN 46228  
UL File No. E507990, see table

### Technical Data

Classification ETIM 5:

ETIM 5.0 Class-ID: EC000005

ETIM 5.0 Class-Description: Cable end sleeve

Classification ETIM 6:

ETIM 6.0 Class-ID: EC000005

ETIM 6.0 Class-Description: Cable end sleeve

Material:

Tinned electrolyte copper

Temperature range:

- 55 °C up to +200 °C

### Note

Other sizes are available upon request.

Photographs and graphics are not to scale and do not represent detailed images of the respective products.

Prices are net prices without VAT and surcharges. Sale to business customers only.

**Conductor end sleeves AH, not insulated**

Article number	Article designation	For mm <sup>2</sup>	UL certification	l1 mm	d1 mm	d2 mm	s mm	Suitable crimp insert	Pieces / PU
Conductor end sleeves AH, not insulated									
62120200	AH DIN 0,5/6	0.5	yes	6	1	2.1	0.15	PEW 12.090	500
62120210	AH DIN 0,75/6	0.75	yes	6	1.2	2.3	0.15	PEW 12.090	500
61721530	AH DIN 0,75/10	0.75	yes	10	1.2	2.3	0.15	PEW 12.090	500
62120220	AH DIN 1/6	1	yes	6	1.4	2.5	0.15	PEW 12.090	500
61721540	AH DIN 1/10	1	yes	10	1.4	2.5	0.15	PEW 12.090	500
62120230	AH DIN 1,5/7	1.5	yes	7	1.7	2.8	0.15	PEW 12.090	500
61721550	AH DIN 1,5/10	1.5	yes	10	1.7	2.8	0.15	PEW 12.090	500
62120240	AH DIN 2,5/7	2.5	yes	7	2.2	3.4	0.15	PEW 12.090	500
61721560	AH DIN 2,5/12	2.5	yes	12	2.2	3.4	0.15	PEW 12.090	500
62120250	AH DIN 4/9	4	yes	9	2.8	4	0.2	PEW 12.090	500
62120260	AH DIN 6/10	6	yes	10	3.5	4.7	0.2	PEW 12.090	500
62120270	AH DIN 10/12	10	yes	12	4.5	5.8	0.2	PEW 12.091	500
62120280	AH DIN 16/12	16	yes	12	5.8	7.5	0.2	PEW 12.091	500

Last Update (04.05.2024)

©2024 Lapp Group - Technical changes reserved

 Product Management [www.lappkabel.de](http://www.lappkabel.de)

You can find the current technical data in the corresponding data sheet.

PN 0456 / 02\_03\_16